

Road Closures

- 1) A bridge on 608 Ave South of 707 Rd will be closed due to a washout. This bridge will remain closed until repairs can be made.

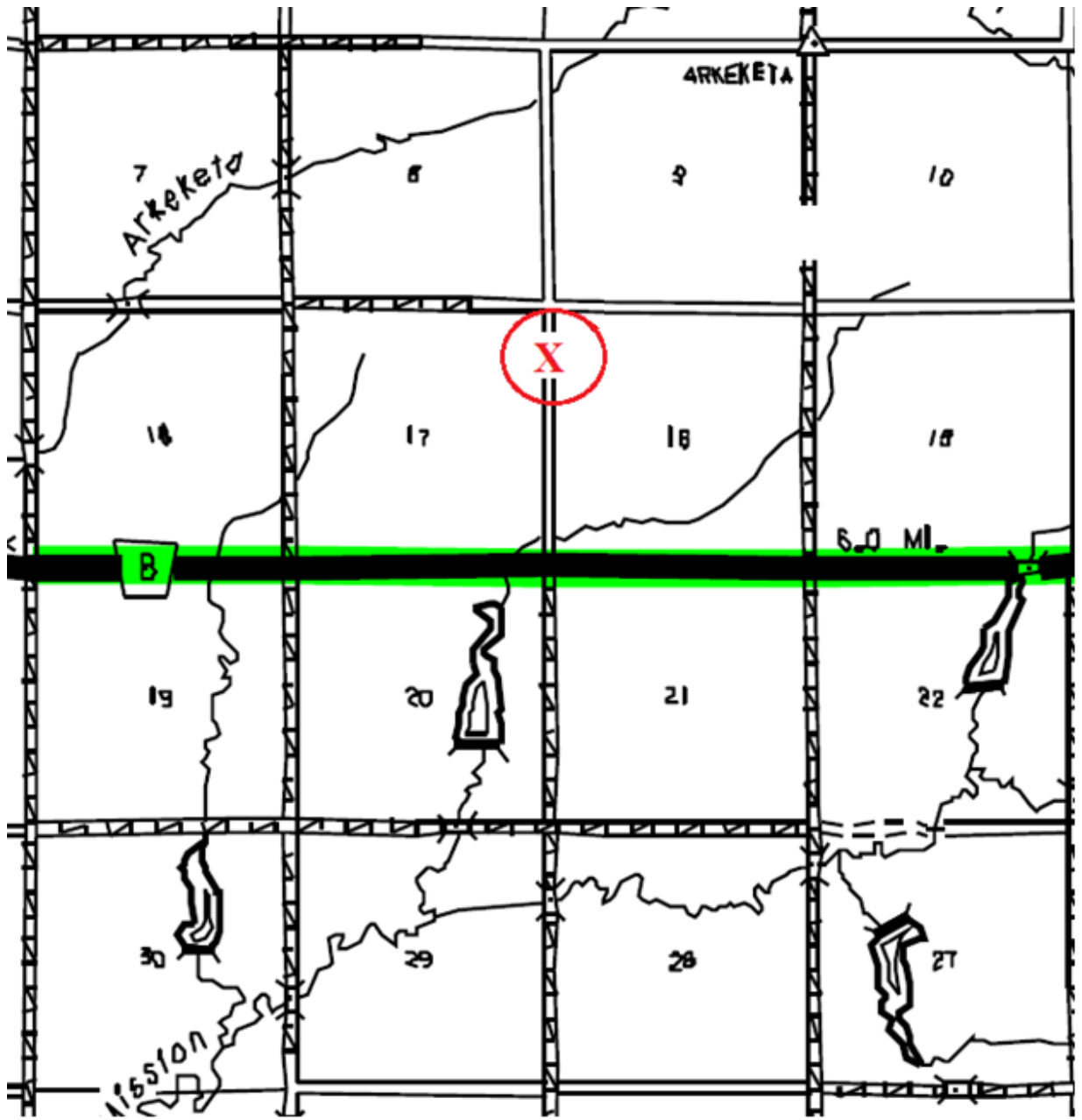

- 2) The Bridge on 616 Ave South of 720 Ave will be closed due to an approach failure until repairs can be made.

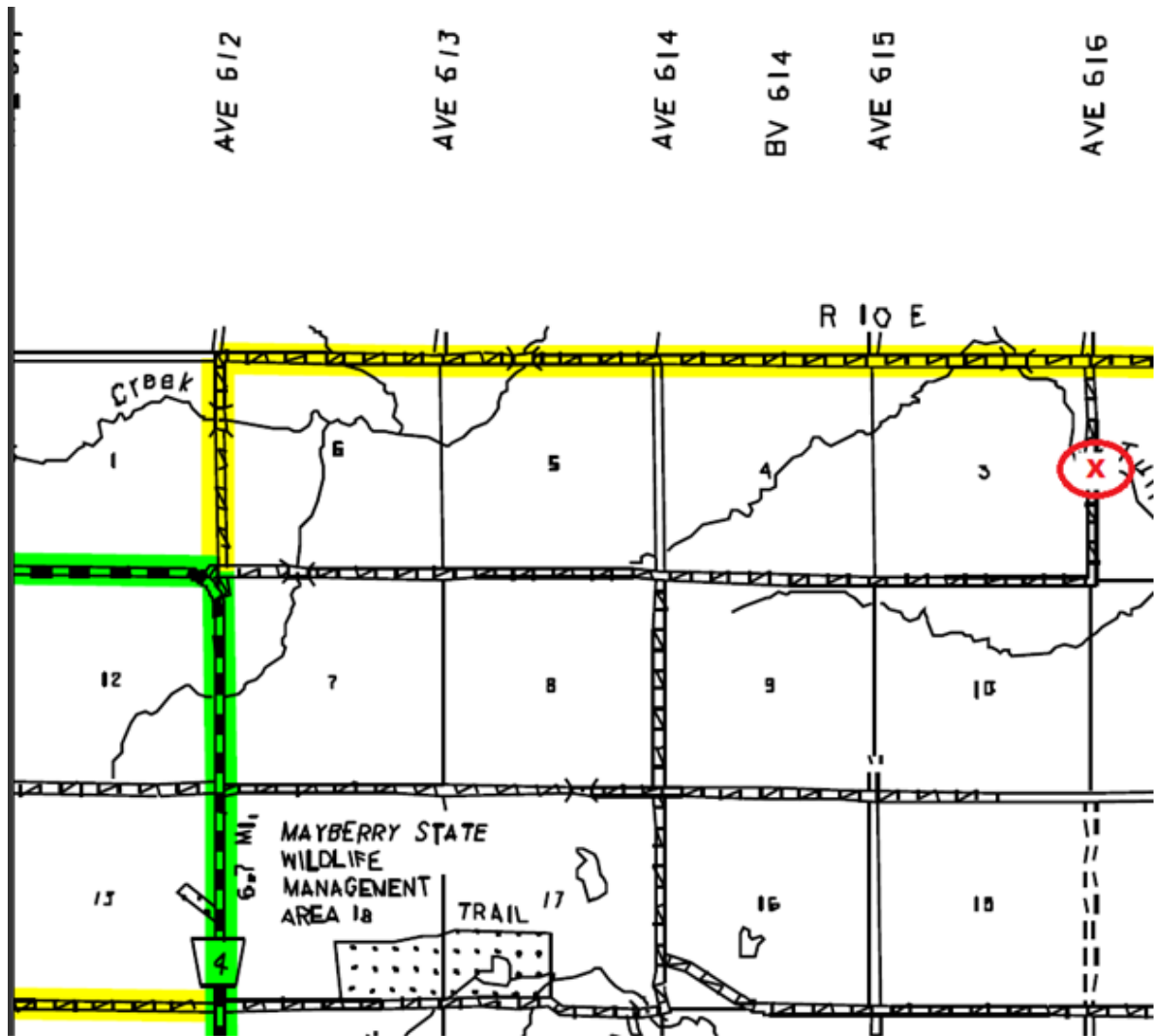

3) 620 Ave South of Highway 8 is closed due to bridge approach failure.

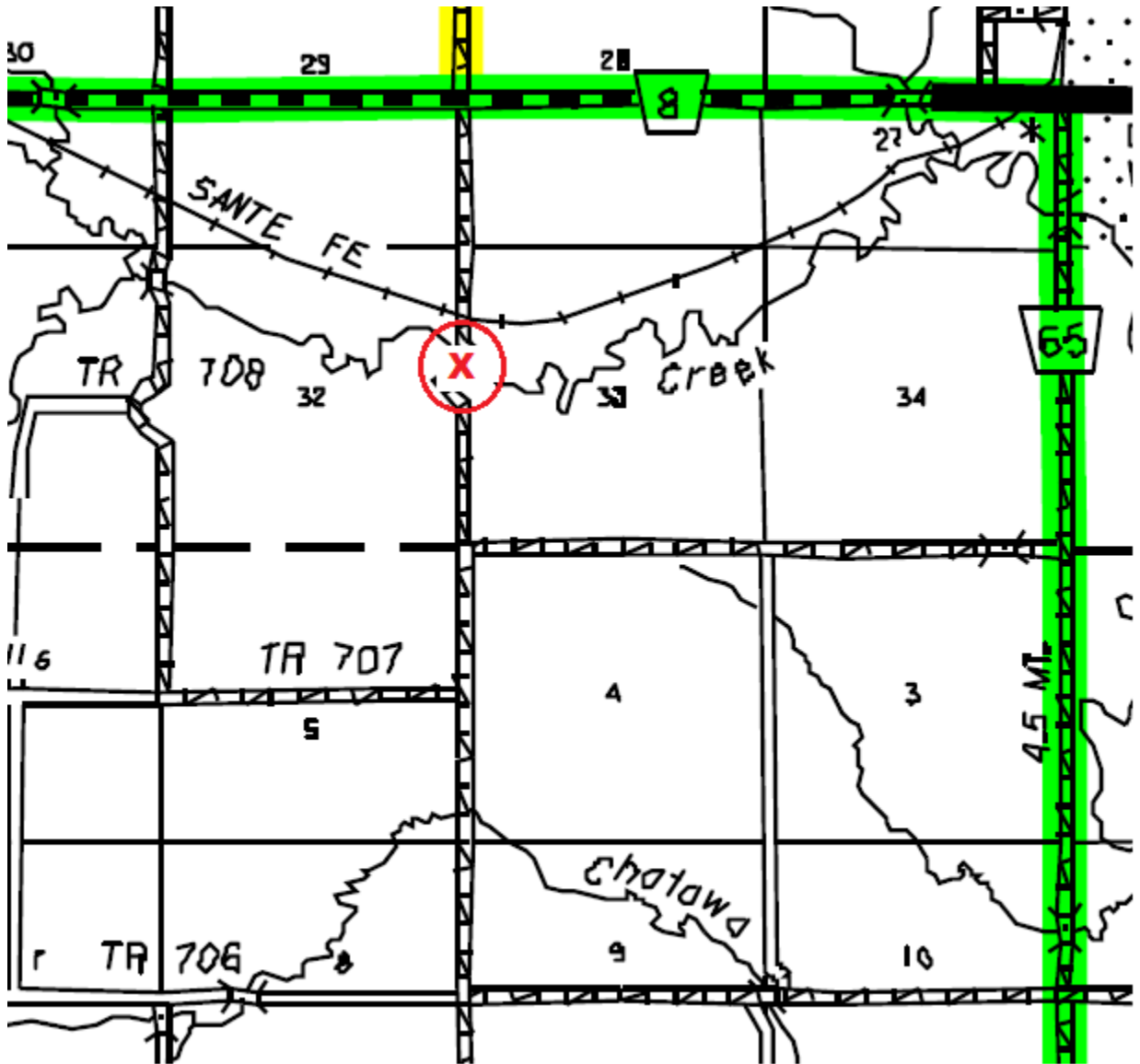

- 4) A Bridge on 623 Ave South of 720 Rd is closed for Replacement.

